



## **Ports of Tilbury and Tilbury2 Notice to Mariners – No. 09 of 2019**

### **The Port of Tilbury (Expansion) Order 2019**

**Please be aware that the above Order was made by the Secretary of State for Transport under the Planning Act 2008 on 20 February 2019 and came into force on the 13 March 2019. The Order authorises the construction, operation and maintenance of a new port terminal, associated facilities and extended ports limits (known as Tilbury 2) at the site of the former Tilbury Power Station.**

**Tilbury 2 comes under the jurisdiction of and will be managed by Port of Tilbury London Limited alongside the existing Port of Tilbury. The port limits for Tilbury 2 are shown outlined in Blue and the Order Limits in Red (until completion of construction) on the accompanying plan.**

**As such Notices to Mariners will be issued by Port of Tilbury London Limited where applicable also for Tilbury 2. This does not affect Notices to Mariners which are issued by the Port of London Authority.**

**For all aspects of marine issues please continue to contact the Lockoffice on 01375 852456 or VHF ch04**

22/03/2019

Port of Tilbury London Limited  
Leslie Ford House  
Essex - RM18 7EH

Capt. Geoff Holland  
Chief Harbour Master



EXPIRY DATE: N/A

A full list of current Notice to Mariners can be found at:-  
<https://www.forthports.co.uk/marine/tilbury-port-authority/>  
Telephone calls, VHF radio traffic, CCTV images may be recorded.





# Ports of Tilbury and Tilbury2 Notice to Mariners – No. 09 of 2019

## The Port of Tilbury (Expansion) Order 2019

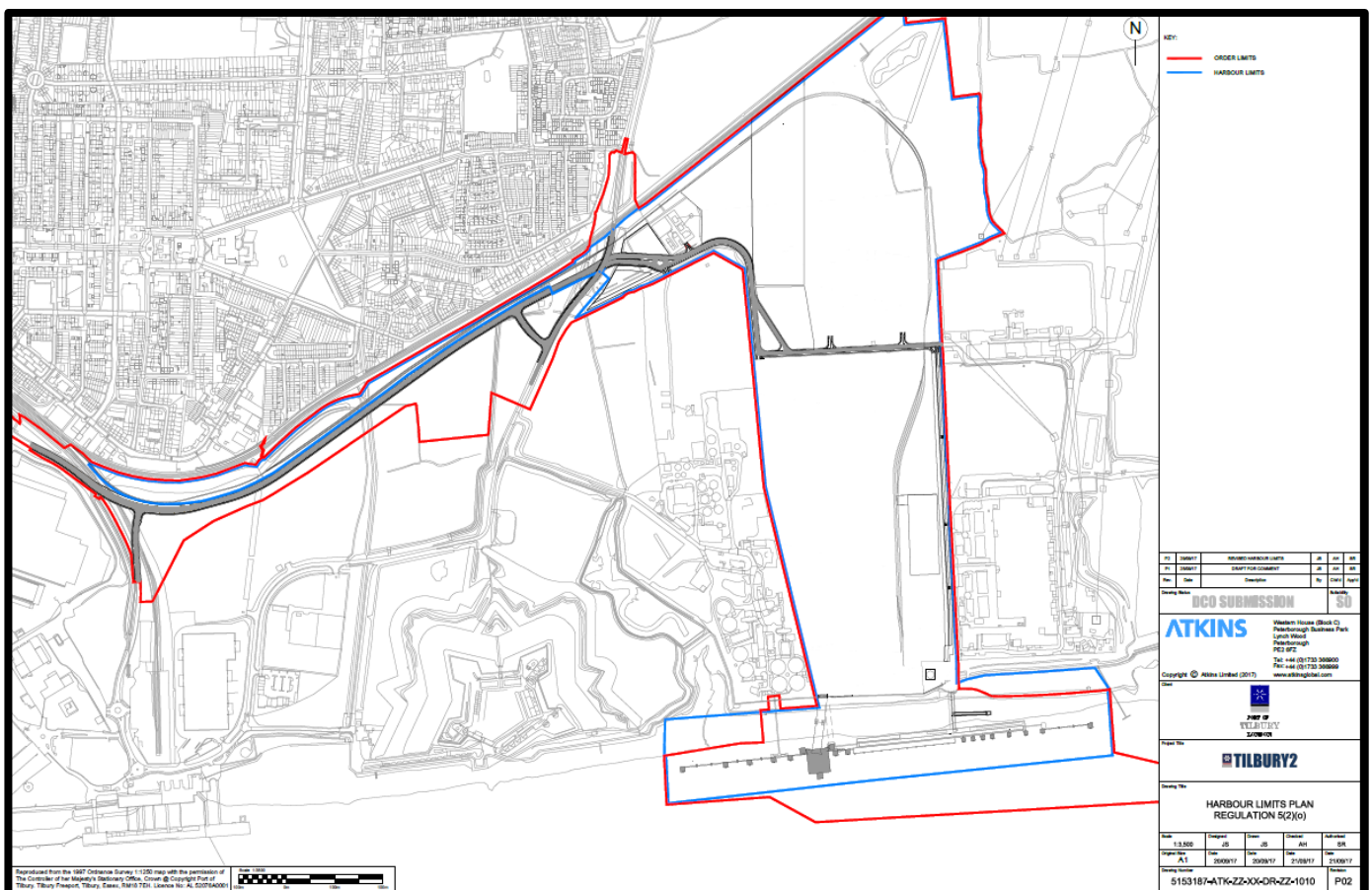

22/03/2019

Port of Tilbury London Limited  
Leslie Ford House  
Essex - RM18 7EH

Capt. Geoff Holland  
Chief Harbour Master



EXPIRY DATE: N/A

A full list of current Notice to Mariners can be found at:-  
<https://www.forthports.co.uk/marine/tilbury-port-authority/>  
Telephone calls, VHF radio traffic, CCTV images may be recorded.

